

NARITA®



Ceramic Tower Heater
Item: NH-1500B

INSTRUCTION MANUAL

FOR HOUSEHOLD USE ONLY

Read all the instructions carefully before you use the appliance and keep the manual for future use.

IMPORTANT INSTRUCTIONS

When using electrical appliances, basic precautions should always be followed to reduce the risk of fire, electric shock, and injury to person(s), including the following:

READ AND SAVE THESE INSTRUCTIONS

READ CAREFULLY BEFORE ATTEMPTING TO ASSEMBLE, INSTALL, OPERATE OR MAINTAIN THE PRODUCTS DESCRIBED. PROTECT YOURSELF AND OTHERS BY OBSERVING ALL SAFETY INFORMATION. FAILURE TO COMPLY WITH INSTRUCTIONS COULD RESULT IN PERSONAL INJURY AND/OR PROPERTY DAMAGE!

RETAIN INSTRUCTIONS FOR FUTURE REFERENCE.

Preparation before operating

1. Check if the electrical voltage of the main supply and the load of the socket match the rated voltage and power marked on the rating label of the appliance.
2. Check if the socket and the plug are undamaged, and put the plug well in the socket.
3. Put the appliance on a stable and flat surface to avoid risk of falling down.
4. Be sure that there is enough space for the ceramic heater while operating, at least 50 cm around the appliance, and right before the air outlet, the distance should be at least 120 cm.

Safety Precautions

- 1) Read all instructions before using this heater.
- 2) This heater is hot when in use. To avoid burns, do not let bare skin touch hot surfaces. If provided, use handles when moving this heater. Keep combustible materials, such as furniture, pillows, bedding, papers, clothes, and curtains at least a 3 feet (a 0.9 m) from the front of the heater and keep them away from the sides and rear.
- 3) Extreme caution is necessary when any heater is used by or near children or invalids and whenever the heater is left operating and unattended.

- 4) Always unplug heater when not in use.
- 5) Do not operate any heater with a damaged cord or plug or after the heater malfunctions, has been dropped or damaged in any manner. Discard heater, or return to authorized service facility for examination and/or repair.
- 6) Do not use outdoors.
- 7) Do not run cord under carpeting. Do not cover cord with throw rugs, runners, or similar coverings. Do not route cord under furniture or appliances. Arrange cord away from traffic area and where it will not be tripped over.
- 9) To disconnect heater, turn controls to off, then remove plug from outlet.
- 10) Do not insert or allow foreign objects to enter any ventilation or exhaust venting as this may cause an electric shock or fire, or damage the heater.
- 11) To prevent a possible fire, do not block air intakes or exhaust in any manner. Do not use on soft surfaces, like a bed, where openings may become blocked.
- 12) A heater has hot and arcing or sparking parts inside. Do not use it in areas where gasoline, paint, or flammable liquids are used or stored.
- 13) Use this heater only as described in this manual. Any other use not recommended by the manufacturer may cause fire, electric shock, or injury to persons.
- 14) Always plug heaters directly into a wall outlet/receptacle. Never use with an extension cord or relocatable power tap (outlet/power strip).
- 15) This heater is not intended for use in bathrooms, laundry areas and similar indoor locations. Never locate heater where it may fall into a bathtub or other water container.

WARNING: This product is equipped with a polarized plug (one blade is wider than the other blade). To reduce the risk of electrical shock, this plug will fit into a polarized outlet only one way. This is a safety feature. If you are unable to insert the plug into the electrical outlet, try reversing the plug. If the plug still does not fit, contact a qualified electrician. Avoid the use of an extension cord because the extension cord may overheat and cause rise of fire. Always plug heaters directly into a wall outlet/receptacle. Never use with an extension cord or relocatable power tap (outlet/power strip).

WARNING: REDUCE THE RISK OF FIRE OR ELECTRIC SHOCK

-DO NOT USE THIS HEATER WITH ANY SOLID STATE SPEED CONTROL DEVICES.

WARNING: DO NOT DEPEND ON THE ON/OFF BUTTON AS THE SOLE MEANS OF DISCONNECTING POWER WHEN SERVICING OF MOVING THE HEATER. ALWAYS UNPLUG THE POWER CORD.

CAUTION: TO PREVENT ELECTRIC SHOCK MATCH WIDE BLADE OF PLUG TO WIDE SLOT, FULLY INSERT TO PREVENT THE PLUG FROM LOOSENING.

ATTENTION : POUR EVITER LES CHOCS ELECTRIQUES, INTRODUIRE LA LAMELA PLUS

LARGE DE LA FICHE DANS LA BORNE CORRESPONDANTE DE LA PRISE ET POT JSSER JUSQU'AU FOND.

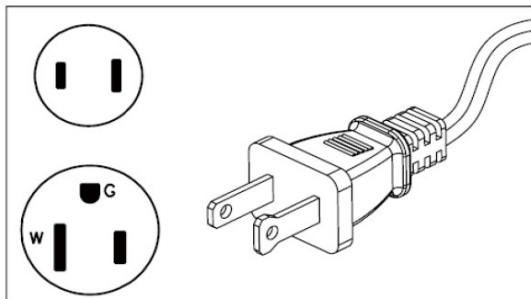

Figure A

SAVE THESE INSTRUCTIONS

Operation instructions

1. Turn the thermostat switch to the minimal value, at the same time turn the heat select switch to the "O" position.
2. Plug in the appliance, and turn the thermostat switch to the maximum position. Then turn the heat select switch to choose air or warm air and the temperature of warm air as below. While working the indicator light will be on.
 - 2.1 Turn the heat select switch to "C" position, the heater blows cool air.
 - 2.2 Turn the heat select switch to "I" position, the heater blows warm air, working at Low.
 - 2.3 Turn the heat select switch to "II" position, the heater blows warm air, working at High.
 - 2.4 Turn the heat select switch to "O" position, the heater stops working, the indicator light will be off.
3. Adjust the thermostat switch to suitable position for desired temperature setting.
 - 3.1 When you feel the room temperature is comfortable, turn the thermostat switch counter-clockwise slowly to the minimal position until the appliance stops working.
 - 3.3 Then the thermostat switch will keep the room temperature at the desired temperature automatically.
4. Tip over safety switch is designed to switch the heater off in the event that it is lifted or falls over. If the heater is placed on a very indented surface or on a

carpet with exceptionally long, soft pile the safety switch may prevent the heater from turning on. Should this happen replace the heater on a firmer, smoother, surface.

- 1、Handle
- 2、Thermostat button
- 3、Switch
- 4、Indicator light
- 5、Air outlet
- 6、Body
- 7、Base
- 8、Tip over switch
- 9、OSC

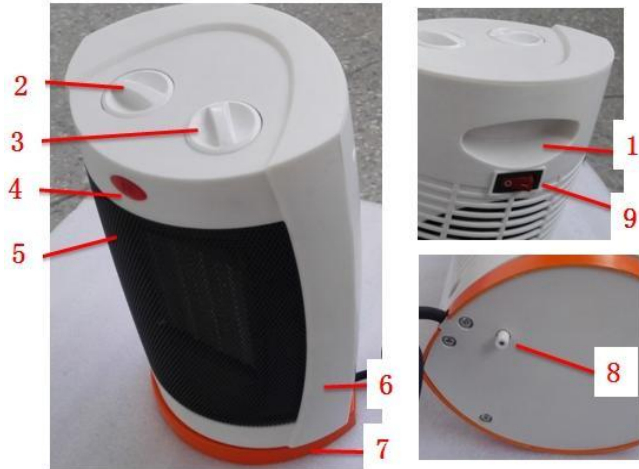

Protective System

1. To avoid risk to human being or damage to internal components, the ceramic heater has a security system which will automatically switch off the appliance if the heat reaches the safety limit. If overheating occurs:
 - 1.1 Turn the heat select switch to “O” position, turn the thermostat switch to the minimal position and remove the plug from the socket.
 - 1.2 Check if the air flows smoothly before the outlet and inlet, and if the appliance is put in right position. If so, get it in order before restarting the appliance.
 - 1.3 Let the ceramic heater cool down for at least 10 minutes before you start it again.
 - 1.4 Plug in the appliance and switch it on. If the appliance cannot operate normally, remove the plug immediately from the socket and have the ceramic heater serviced by an appointed service only.

Maintenance and Cleaning

1. Before you turn off the appliance, turn the heat select switch to the “❄️” position. After operating for 3 to 5 minutes to lower the internal temperature of the appliance, then turn the heat select switch to “O” position.

2. Clean the air inlet and air outlet of the appliance regularly (at least twice a year normally).
3. Before you clean the appliance, turn off the heater first, then remove the plug from the socket, and wait until the appliance cools down.
4. Use a damp cloth to clean the surface of the appliance, avoid water going inside the appliance, dry the appliance before use or storage.

WARNING *To avoid danger of electric shock, unplug from outlet when not in use and before cleaning. If the supply cord is damaged, it must be replaced by the manufacturer or the service agent or a similarly qualified person in order to avoid a hazard.*

Children of less than 3 years should be kept away unless continuously supervised.
Children aged from 3 years and less than 8 years shall only switch on/off the appliance provided that it has been placed or installed in its intended normal operating position and they have been given supervision or instruction concerning use of the appliance in a safe way and understand the hazards involved. Children aged from 3 years and less than 8 years shall not plug in, regulate and clean the appliance or perform user maintenance.
CAUTION — Some parts of this product can become very hot and cause burns. Particular attention has to be given where children and vulnerable people are present.

Any other servicing should be performed by an authorized service representative.



DISPOSAL: Do not dispose this product as unsorted municipal waste. Collection of such waste separately for special treatment is necessary.

This product must not be disposed together with the domestic waste. This product has to be disposed at an authorized place for recycling of electrical and electronic appliances.

By collecting and recycling waste, you help save natural resources, and make sure the product is disposed in an environmental friendly and healthy way.

LIMITED WARRANTY

This unit is warranted against defective materials or workmanship for one year from the date of purchase (warranty is only valid with a dated proof of purchase). The warranty is valid for any manufacturing defects only. This warranty covers operational defects incurred in normal use and does not apply in the case of damage, abuse, mishandling, accident, or failure to follow operation instructions. During the one year warranty period, a product with a defect will be either repaired or replaced with a reconditioned comparable model (at our option). Any return of defective merchandise to the manufacturer must be processed accordingly by contacting customer service first to obtain the Return Authorization Number and freight prepaid with proof of purchase. We will not accept any returns of merchandise without an applicable RMA#.